

EM 4662 P-Li -DYM192107 Parts List

Model : DYM192107		Date: 2018. 5. 10		
Item	Part No.	EN	Qty	Note
1	21051000450001A	blade lock bolt	1	
2	2105300083B	blade	1	
3	2109300062A	flat key	1	
4	2105100015A	blade support	1	
5	A26800100501	self-tapping screw	80	
6	21041007280001A	belt protection cover	1	
7	21041006970001A	bracket	1	
8	21032002520001A	deck	1	
9	21011004150103A	wheel cover	2	
10	A26800502801	hexagonal flange locking nut	12	
11	2103200244A	connecting rod	1	
12	2109800205A	spring	1	
13	2101300065A	angle bearing	4	
14	21011002600001A	wheel assy	2	
15	A26800706202	wave washer	4	
16	21011001460001A	dust proof wheel cover	2	
17	2101200063A	front wheel axle assy	1	
18	A26800202801	tooth screw	2	
19	21041007180103A	mask foundation	1	
20	2101800009A	spring	2	
21	2103100245A	wheel axle fixed block	2	
22	A26800500501	hex locking nut	2	
23	A26800108001	self-tapping screw	2	
24	21011004140103A	wheel cover	2	
25	21011002610001A	wheel assy	2	
26	21011004100001A	dust proof wheel cover	2	
27	A26800900201	open block ring	4	
28	2101500213A	rear wheel axle assy	1	
29	2101100413A	rear wheel axle sheath	1	
30	2101300097A	connecting rod	1	
31	2109200032A	rear wheel axle press plate	2	
32	A26800105502	self-tapping screw	33	
33	2101100411A	rear wheel axle sheath	1	
34	2106200554C	side discharger fixed plate	1	
35	A26800800402	spring washer	2	
36	A26800201501	tooth screw	2	
37	2109800066D	side cover board spring	1	
38	2103300052A	side discharger fixed axle	1	
39	21041007320001A	side cover board	1	
40	21041007580001A	side discharger protector	1	
41	21031002290001A	mulching wedge	1	
42	21091000580001A	rear deflector press plate	1	
43	A26800105402	self-tapping screw	6	

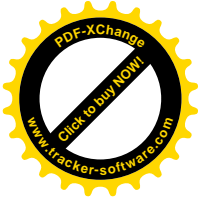
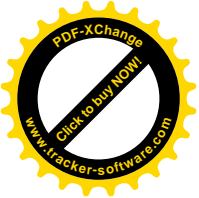

EM 4662 P-Li -DYM192107 Parts List

Model : DYM192107		Date: 2018. 5. 10		
Item	Part No.	EN	Qty	Note
44	21041007170001A	front cover	1	
45	21041007200001A	handle press plate	1	
46	21041007190001A	upper handle cover	1	
47	2108900128A	connecting line of switch	1	
48	21041007130001A	fixed bracket	1	
49	2109200005A	press plate	1	
50	21041007140103A	knob	1	
51	2109200031A	front wheel axle press plate	1	
52	21041007150001A	locating block	1	
53	2108900127A	microswitch	1	
54	21041007090001A	battery compartment	1	
55	21031001550103A	key	1	
56	21041007100001A	front spile	1	
57	A26800107101	self-tapping screw	2	
58	21041007070001A	left side cover	1	
59	21041007040001A	left side cover of power head	1	
60	21041007030103A	cover	1	
61	21041007020001A	cover board	1	
62	21041007060001A	head cover	1	
63	2104100711A	left radial arm	1	
64	A26800701201	washer	2	
65	2104100712A	right radial arm	2	
66	21041007050001A	right side cover of power head	1	
67	21041007080001A	right side cover	1	
68	2108900107A	controller assy	1	
69	21091000490001A	block base	1	
70	2109800203A	spring	1	
71	21091000500001A	block	1	
72	21041006810001A	battery plug	1	
73	21041006890001A	press plate	1	
74	2108900124A	battery welding line	1	
75	21041006800001A	wind sleeve	1	
76	A26800902601	External retaining ring	1	
77	2109100059A	fan blade	1	
78	2059900003A	brushless motor	1	
79	A26800501901	nut	4	
80	3091307008	bolt	4	
81	A26800601701	bolt	4	
82	2104100674A	motor bracket	1	
83	A26800606401	bolt	6	
84	21032002425006A	left handle bracket	1	
85	2109800157A	spring	1	
86	A26800901101	External retaining ring	1	

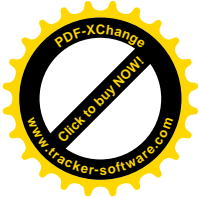
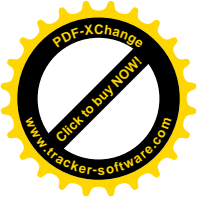

EM 4662 P-Li -DYM192107 Parts List

Model : DYM192107		Date: 2018. 5. 10		
Item	Part No.	EN	Qty	Note
87	2104300005A	pole	1	
88	2104300006A	bracket connecting rod	1	
89	2109800156A	spring	1	
90	21032002435006A	right handle bracket	1	
91	A26800203001A	cross pan head screw	1	
92	2106500005A	handle fixed plate	1	
93	3081301001	cotter	1	
94	A26800710001	flat washer	1	
95	2106800593A	adjust height spring	1	
96	2106500004A	adjust height bar	1	
97	21061006083001A	adjust height handle assy	1	
98	2106300189A	bearing sheath	2	
99	21002003440001A	rear flap	1	
100	3021304002	cross brazier head screw	2	
101	2109200029B	flat washer	2	
102	A26800500801	hex lock nut	2	
103	21041007290001A	lock handle	2	
104	3082306003	elastic cylindrical pin	2	
105	2106300165A	pin	2	
106	2106300166A	bearing sheath	2	
107	2109800200A	lower handle spring	2	
108	21091000030001A	wire clamp	1	
109	21062010700001A	lower handle	1	
110	21061000020001B	lower handle knob	2	
111	21061005670001A	pipe bushing	2	
112	21061005660001A	pipe sleeve	2	
113	A26800600401	flat head bolt	2	
114	A26800502301A	hex nut	2	
115	21062010690001A	upper handle	1	
116	21041007210001A	shift knob	1	
117	21041007220001A	switch box	1	
118	21041007230001A	handle panel cover	1	
119	2108900109A	Power display panel	1	
120	21062010710104A	starter pull rod	1	
121	2106800601A	starter pull rod spring	1	
122	2106100320A	handle sheath	1	
123	21061001113201N	wave washer	4	
124	2104100725A	switch spring seat	1	
125	21061001603201B	drive rod bracket(right)	1	
126	2109800199A	switch spring	1	
127	21061001623201A	pull rod bracket washer	2	
128	2104100727A	switch locating seat	1	
129	21061006350001A	self-propelled cord hanging block	2	

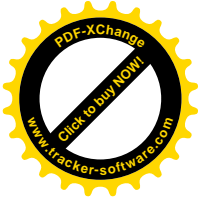
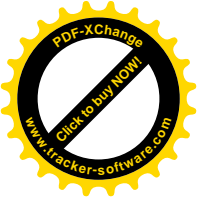

EM 4662 P-Li -DYM192107 Parts List

Model : DYM192107		Date: 2018. 5. 10		
Item	Part No.	EN	Qty	Note
130	2011400032A	switch	1	
131	21061001613201A	pull rod bracket cover	2	
132	2104100724A	pull rod panel cover(lower)	1	
133	21061001593201B	drive rod bracket(left)	1	
134	A26800103701	self-tapping screw	6	
135	2109100038A	press plate	1	
136	2108900122A	connecting line assy	1	
137	2107500004A	grass catcher bracket	1	
138	21077000462133A	grass catcher bag	1	
139	21071000720001A	grass catcher cover	1	
140	21071000730001N	grass catcher handle	1	
141	21071001080103A	level indicator	1	
142	21031002280120A	protection cover	1	
143	2070100072A	charger	1	
144	2060100074A	battery	1	

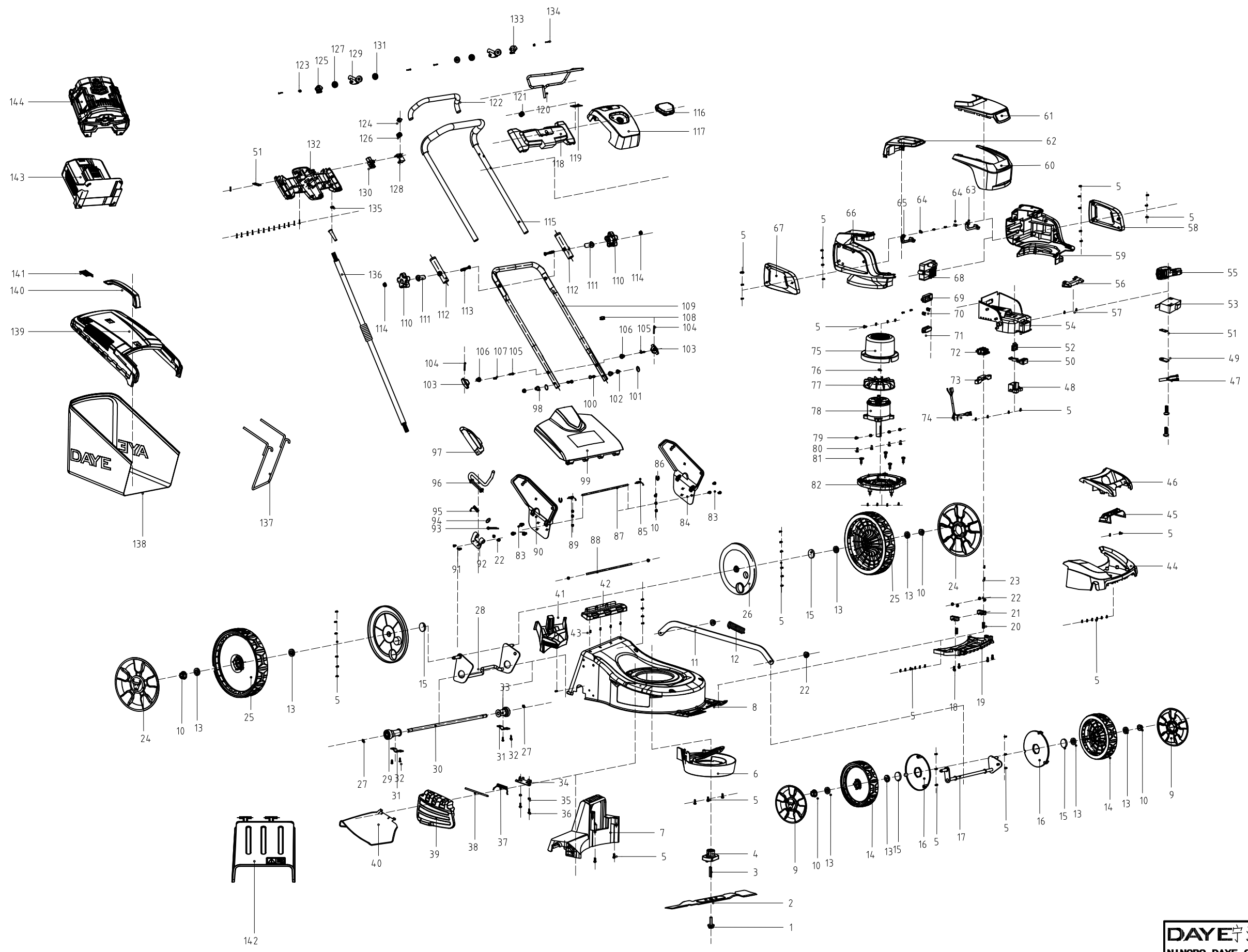

DAYE 宁波大叶园林设备有限公司				产品型号	DYM192107
NINGBO DAYE GARDEN MACHINERY CO., LTD.				图样名称	
设计		标准化		阶段标记	材 料
制图				重量(q)	
审核				比例	1:1
工艺		批准		图幅	图 号
		共 张	第 张	版 本	